



Griffco Valve Inc.

188 Creekside Drive
Amherst, NY 14228 USA
Phone: 1 800-474-3326
Fax: 1 716-835-0893
sales@griffcovalve.com
www.griffcovalve.com

GLASS CALIBRATION COLUMNS

Features:

- High Reliability / Low Cost
- Borosilicate Glass Tube
- 8 End Cap Materials
- Easy Disassembly For Cleaning
- Protective Outer Shield
- High Contrast Graduation Markings
- Metric (mL) and US (GPH) Scales
- Sealed Top with Overflow Connection
- No exposed hardware (Most Models)

Operation:

Griffco calibration cylinders are installed in the suction line to the chemical metering pump. Two isolating valves, (not supplied) must be installed in the suction line as per the drawing below. The top of the cylinder should be vented back to the storage tank or to drain. Fill the cylinder to the top mark then close the valve from the chemical tank. Switch on the chemical feed pump and draw down the chemical in the cylinder for 30 seconds. Switch the pump off. The reading on the right side of the cylinder is a direct readout of USgph. Alternatively, observe the volume withdrawn on the mL scale. To convert to LPH or GPH use this formula:

$$\text{LPH} = 3.6 \times [\text{mL}] \div \text{Time (sec)}$$

$$\text{GPH} = 0.951 \times [\text{mL}] \div \text{Time (sec)}$$

Note: Max. cylinder pressure is 0.45 bar (15 feet of water or 6.5 psi).

Griffco Borosilicate Glass Calibration Cylinders are designed to enhance the performance of chemical feed systems by providing a verification of the flow rate of the chemical feed pump. Constructed of borosilicate glass and a choice of 8 end cap materials, (PVC, CPVC, PP, PTFE, PVDF, 316SS, Alloy 20, and Hastelloy C) these cylinders are suitable for use with most chemicals. Available in 12 sizes; from 30mL to 20 L.

TYPICAL INSTALLATION

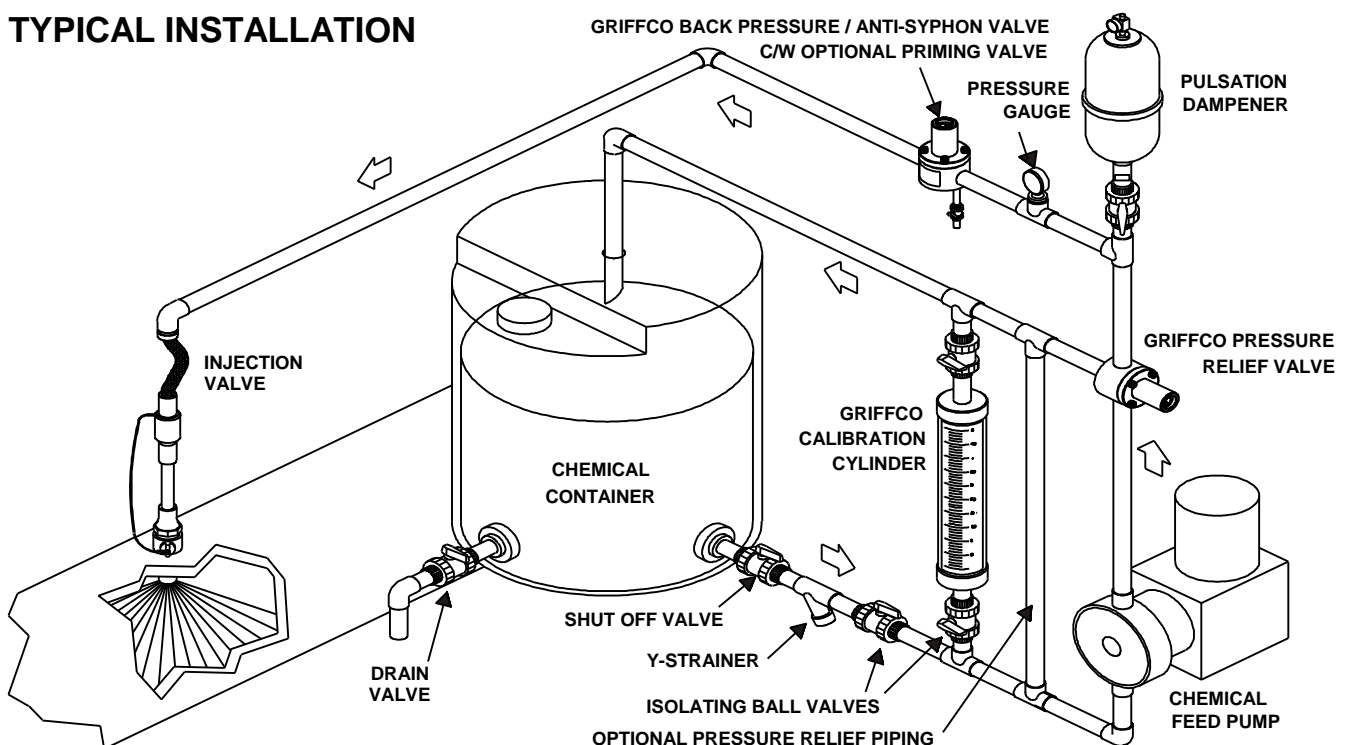

Dimensions:



Ref #	Description
1	End Cap
2	O-Ring ²
3	Split Ring
4	Nut
5	Shield ¹
6	Glass Tube

¹Shield, not standard on 10,000 to 20,000 mL sizes.

²FKM (Viton®) O-Ring is standard

Capacity (mL) ◇	Max Flow ▲ (USgph)	Scale (lph)	Scale (mL)	Scale ▲(gph)	A cm (in)	B cm (in)	C – Size Connection
30	.95	3.6	1	0.05	35.6 (14)	3.6 (1.4)	1/4"
100	3.2	12	2	0.1	38.1 (15)	6.4 (2.5)	1/2" DN15
200	6.4	24	2	0.1	53.3 (21)	6.4 (2.5)	1/2" DN15
500	16	60	5	0.2	38.1 (15)	8.9 (3.5)	3/4" DN20
1,000	32	120	5	0.2	68.6 (27)	8.9 (3.5)	3/4" DN20
2,000	63	240	10	1	68.6 (27)	12.7 (5.0)	1" DN25
4,000	127	480	10	1	99.1 (39)	12.7 (5.0)	1" DN25
5,000	160	600	10	1	73.7 (29)	19.1 (7.5)	1.5" DN40
7,000	225	840	10	1	99.1 (39)	19.1 (7.5)	1.5" DN40
10,000 ¹	320	1200	100	5	68.6 (27)	23.2 (9.15)	2" DN50
15,000 ¹	480	1800	100	5	99.1 (39)	23.2 (9.15)	2" DN50
20,000 ¹	640	2400	100	5	129.5 (51)	23.2 (9.15)	2" DN50

▲ Max Flow and gph scale are based on 30 second drawdown

◇ For 60 sec draw down, double capacity in mL or flow size

¹Shield, not standard on 10,000 to 20,000 mL sizes

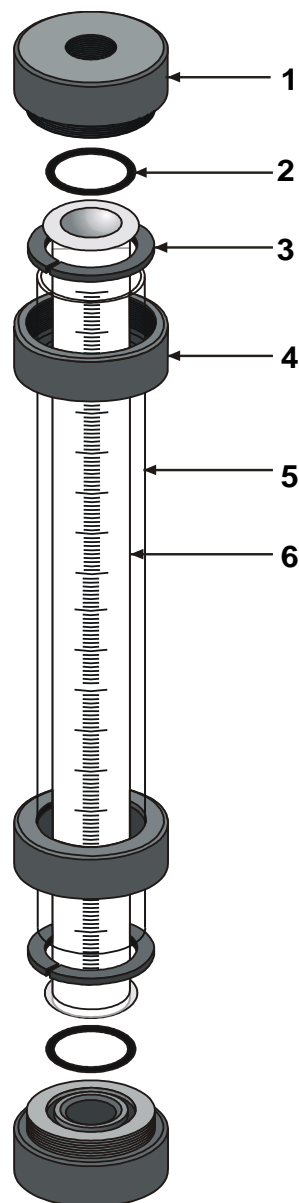

Codes for Ordering Glass Calibration Columns:

CCG

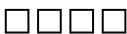

1



2

3

4

1 = Size

2 = End Cap
Material

3 = Connection

4 = Option/Oring Material
(Union & regular end cap orings)

0030 – 30 mL

0100 – 100 mL

0200 – 200 mL

0500 – 500 mL

1000 – 1000 mL

2000 – 2000 mL

4000 – 4000 mL

5000 – 5000 mL

7000 – 7000 mL

10000 – 10000 mL

15000 – 15000 mL

20000 – 20000 mL

P – PVC

CP – CPVC

PP – Polypro

T – PTFE

K – PVDF

M – 316 SS

A – Alloy 20

C – Hastelloy C

Blank – NPT Threads

B – BSPT Threads

S – Socket

SD – Metric Socket

F – Flanged

FD – Metric Flanged

U – Union

UD – Metric Union

Blank – FKM (Viton®) Oring

E – EPDM Oring

R – Compression Rods (SS)

(PTFE Encapsulated
or FFKM are available
upon request)

Connection Configurations

